



**GOLD MEDAL® PRODUCTS CO.**

# Lil' Maxx

Model No. 2389

## Specifications

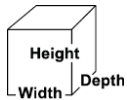
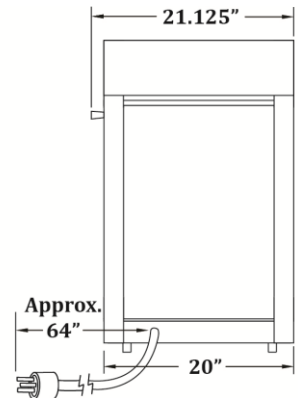
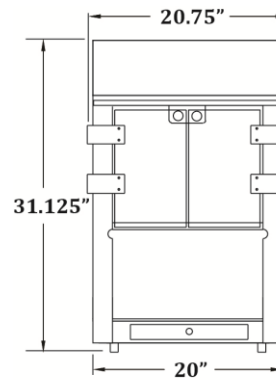

### Overall Dimensions:

**Width:** 20.75"  
**Depth:** 21.125"  
**Height:** 31.125"

### Features:

- 8 oz. Stainless Steel Kettle
- Ideal Cart 2148CR (sold separately)
- Spacer 13318 (sold separately)

### Electrical - Domestic

120V  
1250 WATTS 60 Hz  
(NEMA 5-15P) Plug

### Plug Type: Agency Approvals:



**Gold Medal Products Co.**  
10700 Medallion Drive, Cincinnati, OH 45241

Ph: (513) 769-7676, (800) 543-0862; Fax: (513) 769-8500  
gmpopcorn.com info@gmpopcorn.com