



Your Solutions Partner

# Specifications

F.O.B. Sedalia, Missouri 65301



**WB303**

### OPTIONS:

- Cold pan style top
- Drop type brackets for cutting board
- Stainless steel feet
- Adapter plates
- Trayslides & Workshelves
- Foodshields

### AGENCY LISTINGS:



UL/ANSI 4



DUKE MANUFACTURING CO.

2305 N. Broadway

St. Louis, MO 63102

800.735.3853 Toll Free

314.231.5074 Fax

www.dukemfg.com

SS-1096 Aerohot Wet Bath - Gas

### Approval Stamp(s):

#### PRODUCT INFORMATION:

PROJECT: \_\_\_\_\_

ITEM: \_\_\_\_\_

QUANTITY: \_\_\_\_\_

#### MODEL:

Aerohot™ Foodservice

Hot Food Units - Gas Wet

- WB302                      2 top openings
- WB303                      3 top openings
- WB304                      4 top openings
- WB305                      5 top openings

#### Type of gas:

- Natural            High altitude orifice available
- Propane           specify elevation:

#### TOP:

- 20 gauge, stainless steel
- Die-stamped openings - 12" x 20"
- Poly carving board - 7"W x 1/2" thick with 18 gauge stainless steel support shelf and die-stamped brackets

#### LINER:

- 18 gauge, stainless steel - 8" deep
- 1" cast brass drain and valve in wet bath

#### BODY AND INTERIOR SHELF:

- 20 gauge, 430 Series stainless steel body
- 20 gauge, 430 Series stainless steel undershelf
- 430 Series stainless steel tubular legs with adjustable plastic feet

#### CONTROLS:

- Natural or Propane, as specified
- Gas safety pilots standard
- Gas pressure regulator furnished in each unit
- Burners controlled by adjustable valve

**NOTE:** Not available with casters

Specification subject to change



# Aerohot® Food warmer - Gas - Wet

A.I.A. File No. 35-C-13

Catalog No. AFS-GASWET

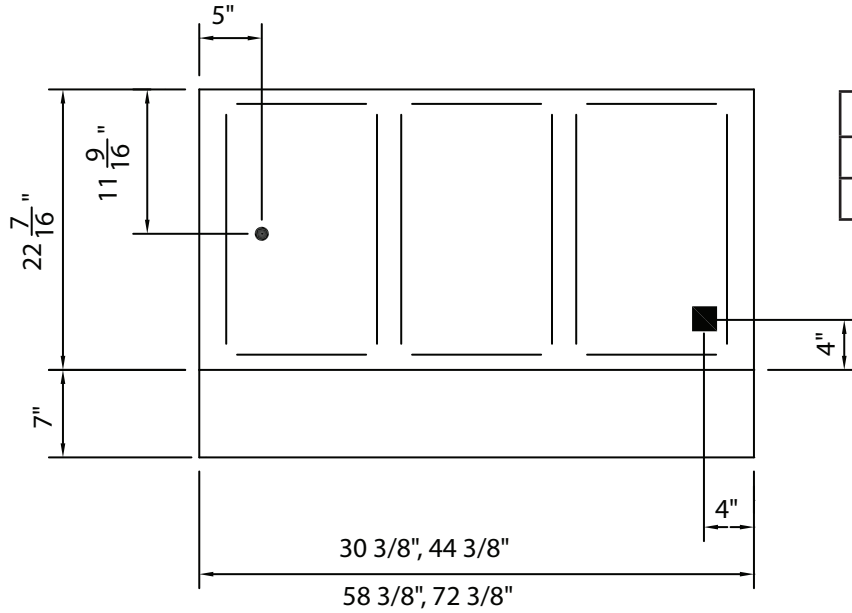

LEGEND	
	GAS CONNECTION - 1/2" Connection
●	DRAIN CONNECTION - 1" CAST BRASS

**TOP VIEW**

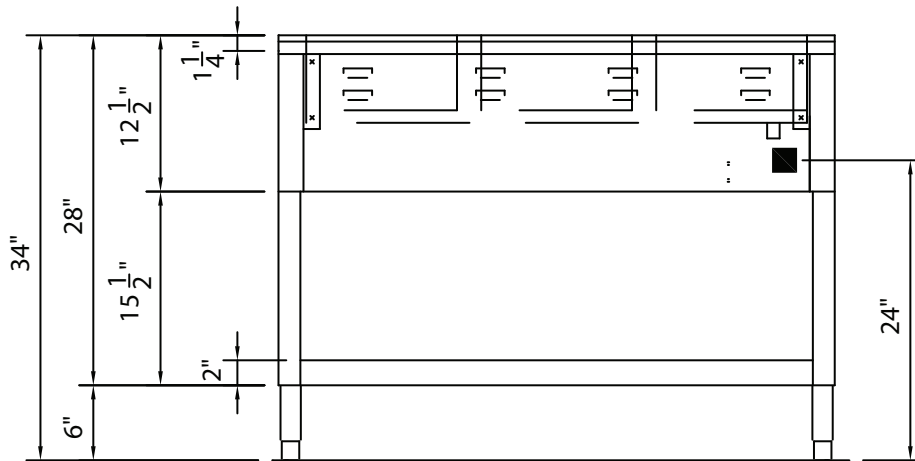

**FRONT VIEW**

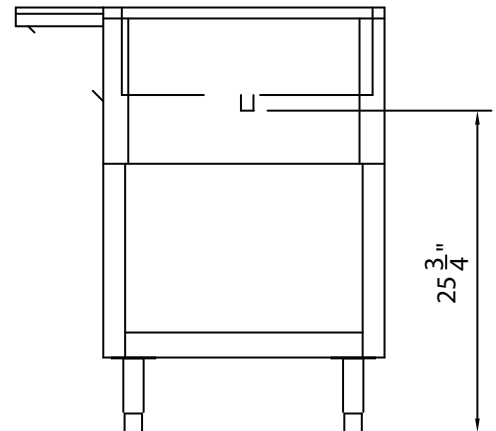

**RIGHT SIDE VIEW**

**DIMENSIONS:**

**Freight Class: 85**

Model	Total BTU	Length		Width		Height		Top Openings	Cube ft. Crated	Weight	
		in	cm	in	cm	in	cm			lbs	kg
WB302	15,000	30-3/8	77.2	22-7/16	57.1	34	86.4	2	27.0	110	49.9
WB303	15,000	44-3/8	112.8	22-7/16	57.1	34	86.4	3	38.1	135	61.2
WB304	27,500	58-3/8	148.3	22-7/16	57.1	34	86.4	4	49.2	160	72.6
WB305	27,500	72-3/8	183.9	22-7/16	57.1	34	86.4	5	60.2	195	88.4

AEROHOT™ FOODSERVICE - HOT FOOD UNITS - GAS



**Duke Manufacturing Co.**  
 2305 N. Broadway  
 St. Louis, MO 63102

Phone: 314-231-1130  
 Toll Free: 1-800-735-3853  
 Fax: 314-231-5074

[www.dukemfg.com](http://www.dukemfg.com)

Printed in U.S.A  
 © 2019, Duke Manufacturing Co.