

SUPER DUTY NON-INSULATED TRANSPORT CABINET MODEL 100-1841-DSD

FEATURES AND BENEFITS:

- Non-insulated super-duty all purpose cabinet for rough handling during transport.
- Same size top and base extend past sidewalls to act as natural bumpers for protection. Extruded frame fully welded
- Body constructed of specially reinforced non-corrosive, Hi-Tensile aluminum for extra strength.
- Double reinforced, full length door swings 270° and can be latched to the cabinet side for convenience. Card clip included.
- Gravity type latch secures door during transport.
- Heavy duty hinges.
- Corrugated sidewalls securely hold 18" x 26" pans on 1-1/2" centers without tipping. Provides added strength.
- Heavy duty 5" swivel casters, two with brakes. Provides mobility when fully loaded.



100-1841-DSD
(Shown with optional corner bumpers)



ACCESSORIES and OPTIONS (Available at extra cost):

- Lock Hasp
- Various Caster Options
- Corner Bumpers
- Perimeter Bumper
- Floor Lock (for use with 5" casters)
- Push Handle
- Bail Handles
- Left-Hand Hinged Door
- Kold Keepers

See page A-20 for accessory details.

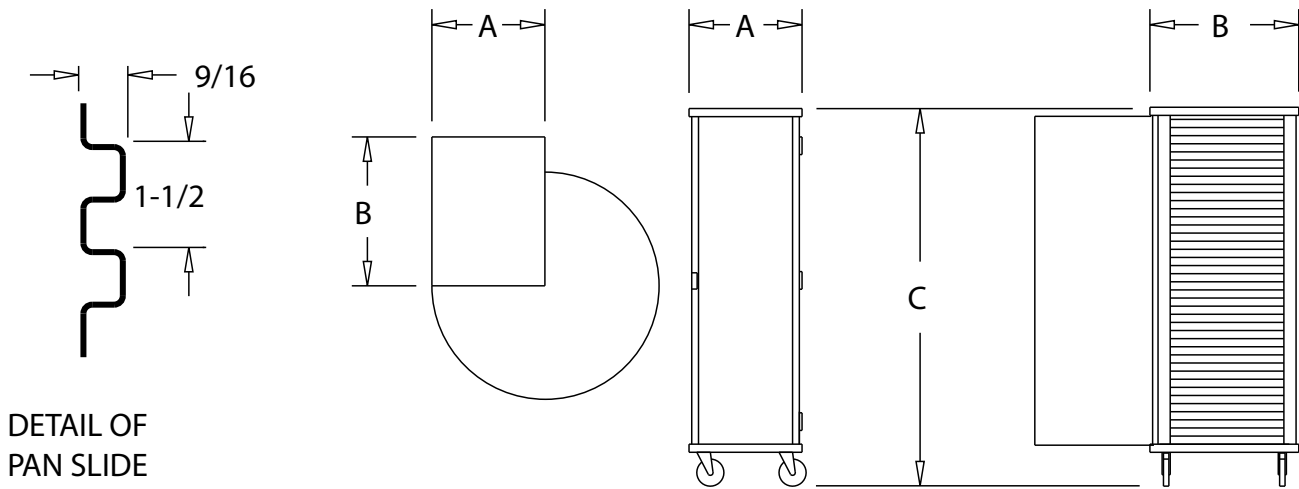

CRES COR MODEL NO.	PAN			DIM "A"	DIM "B"	DIM "C"	INSIDE DIMENSIONS			WEIGHT ACT.	
	CAP	SIZE		WIDTH	DEPTH	HEIGHT	WIDTH	DEPTH	HEIGHT		
100-1841-DSD	39	18 X 26	IN	20-7/8	27-1/2	69-3/4	18-1/16	26	61-1/2	LBS	108
		460 X 660	MM	530	700	1775	460	660	1565	KG	49

NOTE: Send sample pan or tray with order when using any that are not an 18" x 26" pan with heavy beaded edge. When ordering bumpers, add 2" to overall dimensions.

ALL ALUMINUM CONSTRUCTION IS RIVETED, WELDED AND FINISHED.

CABINET:

- Posts: Extruded channels, 7/8 x 2-1/4 x .102, welded to top and base, form a solid frame.
- Sides: .063 corrugations riveted to posts.
- SUPER DUTY back panel: Fitted into posts, riveted to top and reinforced with additional bracing.
- Tie rods: Two are applied at front
- Top: One piece .100 aluminum.

BASE:

- One piece construction, .190 aluminum.
- Casters: 5" dia., swivel, modulus tires, 1-1/4 wide, load cap. 250 lbs. each, temp. range -45°/+180°F. Delrin bearings. Front casters equipped with brakes.

DOOR:

- Panel: .063 aluminum, fitted into extruded frame, 3/4 x 1-7/16 x .187.
- SUPER DUTY reinforcement: Five 1/4 x 1-1/2 extruded bars riveted and welded horizontally.
- Latch: Gravity type, nickel plated steel.
- Swings 270° on 3 heavy duty butt hinges, riveted to posts and frame.

PAN SLIDES:

- Corrugations act as pan slides on 1-1/2" centers.

SHORT FORM SPECIFICATIONS

Cres Cor Super Duty Cabinet Model 100-1841-DSD. Formed and welded .100 aluminum top, .190 aluminum base. No-tip .063 corrugated aluminum sides for (39) 18" x 26" pans on 1-1/2" centers. .063 aluminum door; full frame welded construction. Two additional extruded bars riveted and welded to door and back. 5" swivel modulus casters, Delrin bearings. Load capacity 250 lbs. each. 2-Year Parts / 1-Year Labor warranty. Provide the following accessories: _____ NSF listed.



5925 Heisley Road • Mentor, OH 44060-1833
 Phone: 877/CRESCOR • Fax: 440/350-7267
 www.crescor.com

© Crescent Metal Products, Inc. 2011 All rights reserved.

In line with its policy to continually improve its products, CRES COR reserves the right to change materials and specifications without notice.